



MODEL YAMAHA XSR 700

YEAR 2016 - 2020

SCHEMATIC

LINE FULL SYSTEM

MUFFLER GHIBLI

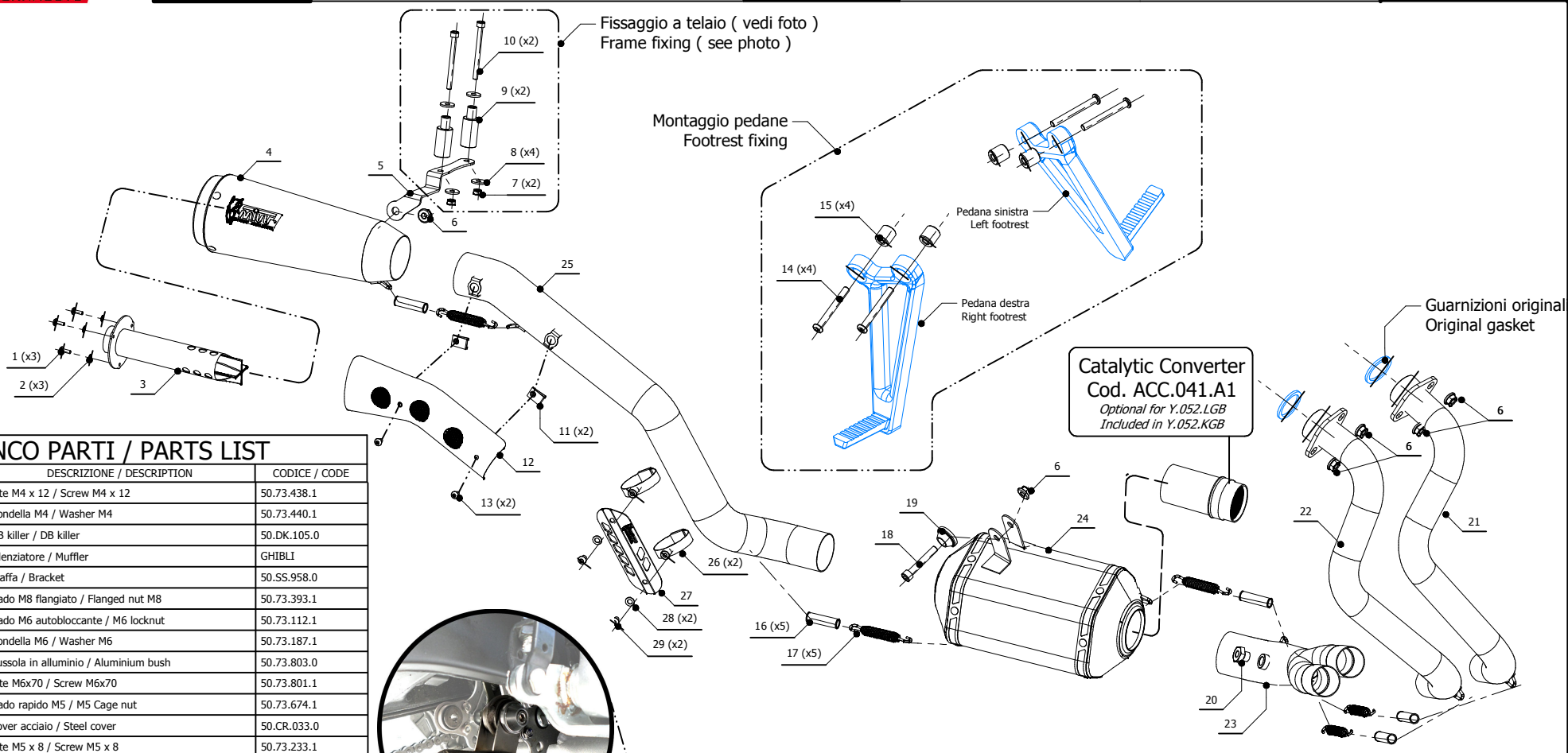

ELENCO PARTI / PARTS LIST

| # | QTÀ / QTY | DESCRIZIONE / DESCRIPTION | CODICE / CODE |
|----|-----------|---------------------------------------------------|---------------|
| 1 | 3 | Vite M4 x 12 / Screw M4 x 12 | 50.73.438.1 |
| 2 | 3 | Rondella M4 / Washer M4 | 50.73.440.1 |
| 3 | 1 | DB killer / DB killer | 50.DK.105.0 |
| 4 | 1 | Silenziatore / Muffler | GHIBLI |
| 5 | 1 | Staffa / Bracket | 50.SS.958.0 |
| 6 | 6 | Dado M8 flangiato / Flanged nut M8 | 50.73.393.1 |
| 7 | 2 | Dado M6 autobloccante / M6 locknut | 50.73.112.1 |
| 8 | 4 | Rondella M6 / Washer M6 | 50.73.187.1 |
| 9 | 2 | Bussola in alluminio / Aluminium bush | 50.73.803.0 |
| 10 | 2 | Vite M6x70 / Screw M6x70 | 50.73.801.1 |
| 11 | 2 | Dado rapido M5 / M5 Cage nut | 50.73.674.1 |
| 12 | 1 | Cover acciaio / Steel cover | 50.CR.033.0 |
| 13 | 2 | Vite M5 x 8 / Screw M5 x 8 | 50.73.233.1 |
| 14 | 4 | Vite M8 x 70 / Screw M8 x 70 | 50.73.802.1 |
| 15 | 4 | Distanziale in alluminio / Aluminium spacer | 50.SS.073.1 |
| 16 | 5 | Tubo in gomma per molla / Rubber pipe for spring | 50.73.210.1 |
| 17 | 5 | Molla media / Mid-size spring | 50.73.359.1 |
| 18 | 1 | Vite M8x50 / Screw M8x50 | 50.73.074.1 |
| 19 | 1 | Rondella alluminio / Aluminium washer | 50.73.291.1 |
| 20 | 1 | Tappo per sonda lambda / Stopper for lambda probe | 50.73.111.1 |
| 21 | 1 | Collettore #1 / Down pipe #1 | 9773Y044C1A |
| 22 | 1 | Collettore #2 / Down pipe #2 | 9773Y044C1B |
| 23 | 1 | Tubo di raccordo 2-1 / Link pipe 2-1 | 9773Y052C1C |
| 24 | 1 | Silenziatore / Muffler | 9873Y046SHXA |
| 25 | 1 | Tubo di raccordo / Link pipe | 9773Y052SGX |
| 26 | 2 | Fascetta con bussola / Pipe clamp with bush | 50.73.333.0 |
| 27 | 1 | Copertura in alluminio / Aluminium cover | 50.CR.012.0 |
| 28 | 2 | Rondella M6 / Washer M6 | 50.72.027.1 |
| 29 | 2 | Vite M6 x 8 / Screw M6 x 8 | 50.72.026.1 |

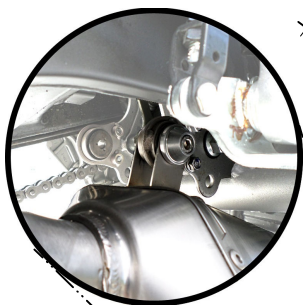

Rimuovere vite e bussola originale
Remove original screw and bush

Assemblare componenti MIVV come mostrato
Assembly MIVV parts as shown

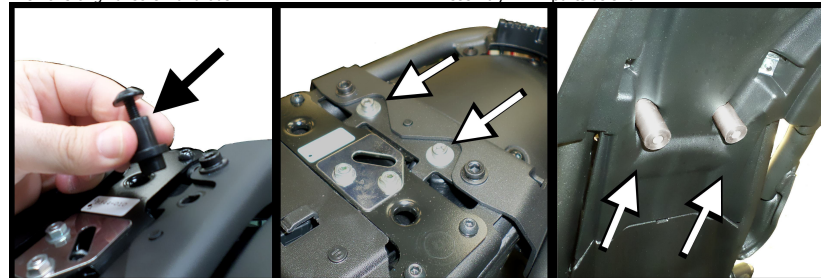

APPLICAZIONI / APPLICATIONS

| CODICE / CODE | TUBO / PIPE | SILENZIATORE / MUFFLER | NOTE |
|---------------|------------------|------------------------|----------------------------------|
| Y.052.LGB | INOX / ST. STEEL | STEEL BLACK | CATALYTIC CONVERTER NOT INCLUDED |
| Y.052.KGB | INOX / ST. STEEL | STEEL BLACK | CATALYTIC CONVERTER INCLUDED |